



# WATER-BASED COATING SYSTEM FOR DECKING, BEACH HUTS AND POOLSIDE FURNITURE



HIGH ADHESION  
IN HIGH HUMIDITY  
ENVIRONMENTS

HIGH STABILITY  
AGAINST SUNLIGHT AND  
OUTDOOR EXPOSURE

EXCELLENT RESISTANCE  
TO WATER

SEASIDECK:  
PROTECTION FOR WOOD  
ON THE BEACH





## SEASIDE COATING SYSTEM

For its natural appeal and strong identity, wood is the best choice for any outdoor environment where a stylish, elegant and functional design is required.

The essential elegance of natural wood must, however, be protected against the elements: resistance to exterior weathering and durability are therefore crucial.

**SEASIDECK** is an extremely versatile outdoor coating system, designed for decking, beach huts, resorts, garden furniture, gazebos and benches, where application on site by brush or roller is often needed.

The coating system has been designed to provide high outdoor durability, excellent adhesion (even in high humidity environments) and outstanding water resistance, all very important characteristics for the end use conditions.

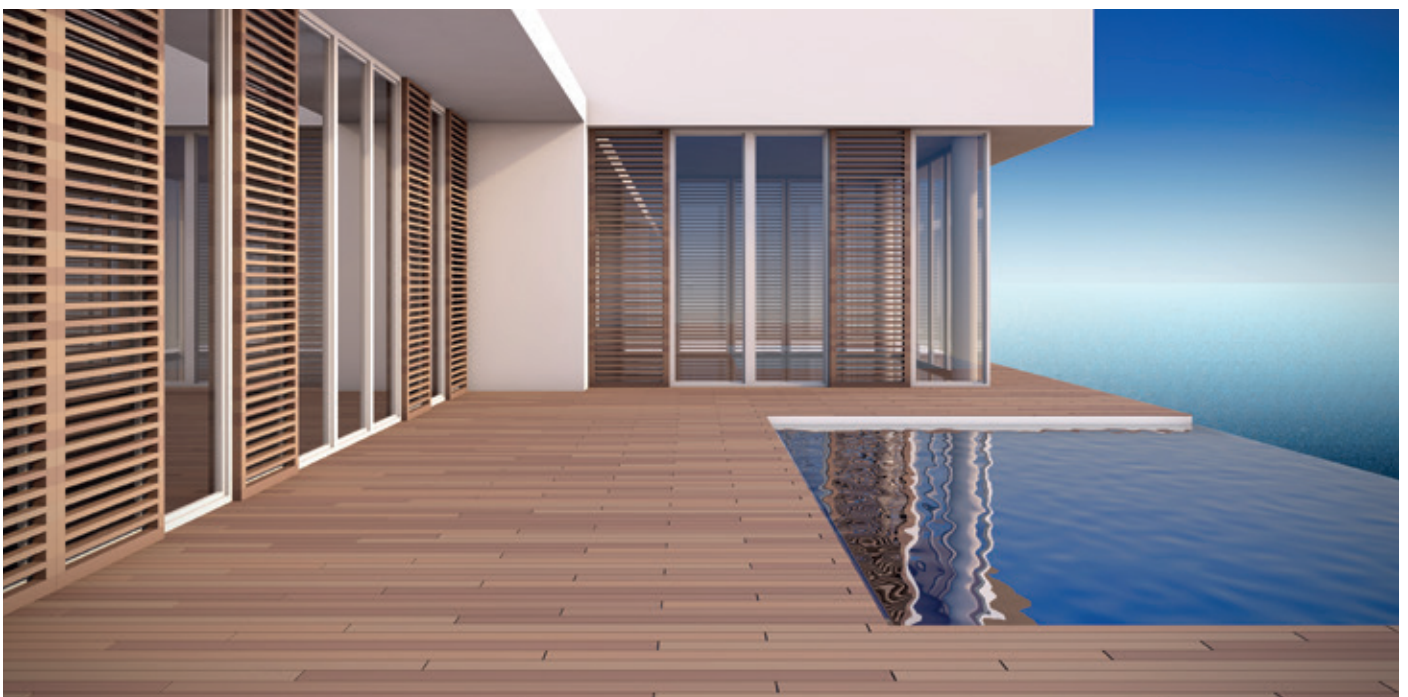



## FOR DECKING, BEACH HUTS AND POOLSIDE FURNITURE

The deck allows us to walk barefoot on a terrace by the sea, to go directly from the wood to the water, in a natural way.

**SEASIDECK**, created for seaside and design, protects and beautifies your deck.



The coating system comprises application of the specific exterior wood stain **AML3542/XX** followed by a water-based, matt high performance topcoat for deck such as **AZL3541/XX** or **AZL6288/85**.

**AML3542/XX** is a water-based exterior wood stain with high wood penetration and wettability, specific for hardwood such as doussié, teak, iroko, mahogany, lack wood, kumbuk, niangon, thulan, etc. and modified timbers such as accoya and thermo pine.

It contains new generation additives to reduce lignin degradation, which combined with semitransparent iron oxides, give high color stability against UV exposure.

**AML3542/XX** is available in four different colors (85/89/90/92) and one neutral version (N0) and is compatible with **XA4034/XX** and **XA2006/XX** pastes to obtain all desired shades.

**AZL3541/XX** is a deep matt water-based high performance topcoat that, with its low sheen (4 gloss) and its excellent penetration into hardwoods, creates a natural wood effect on decking.

Available in larch color **AZL3541/85** and neutral version **AZL3541/NN**, and can be tinted with **XA4034/XX** and **XA2006/XX** pastes.

For an optimum clarity over dark stains an alternative topcoat is 25 gloss version in larch colour **AZL6288/85**.

Apply the **AML3542/XX** water-based exterior wood stain directly on to well sanded wood and after approximately two hours drying apply the first coat of water-based deck topcoat **AZL3541/XX** or **AZL6288/85**.

For higher build and protection, apply a second topcoat after 4 hours drying without sanding.

With longer drying times it's necessary to sand with 220 grit abrasive paper before applying the second coat of deck topcoat



# SEASIDECK FOR DECKING, BEACH HUTS AND POOLSIDE FURNITURE

## TECHNICAL CHARACTERISTICS OF THE PRODUCTS

|                                      |   |
|--------------------------------------|---|
| <b>Application</b>                   | AML3542/XX: dipping, brush, roller                    |
|                                      | AZL3541/XX - AZL6288/85: brushm roller, manual spray  |
| <b>Raw or pre-treated substrates</b> | Properly sanded wood suitable for outdoor use         |
| <b>Drying</b>                        | 2h between exterior wood stain and deck topcoat       |
|                                      | 4h between the topcoats                               |
| <b>Stackability</b>                  | 16h after application                                 |
| <b>Dilution</b>                      | Ready to use  |
| <b>Tinting</b>                       | With XA4034/XX and XA2006/XX pastes for both products |

DEEP PENETRATING EXTERIOR WOOD STAIN

EXCELLENT PERFORMANCE IN ARTIFICIAL  
ATMOSPHERE CORROSION TEST – ISO 9227 2006

Technical Service: Ph. +39 051 770770 - Fax +39 051 770521 customerservice@sayerlack.com

**Sherwin-Williams Italy S.r.l. - Export Department**  
Via del Fiffo 12 - 40065 Pianoro (BO) - Italia  
Ph. +39 051 770511 - Fax +39 051 770528  
export@sayerlack.it - www.sayerlack.com

**SAYERLACK**  
INNOVATIVE WOOD SOLUTIONS

Sayerlack is a brand of The Sherwin Williams Company